

## Internet Explorer Settings for IMF applications

In order to properly use IMF applications with Internet Explorer 7 and 8 the browsers security settings will have to be adjusted.

1. Open the internet Options panel by selecting in the menu **Tools | Internet Options**
1. Open the Security Setting panel by selecting the Security tab and the select the Custom Level... button near the bottom of the panel.

**Fig1. Internet Options Panel**



**Fig2 Security Settings Panel**

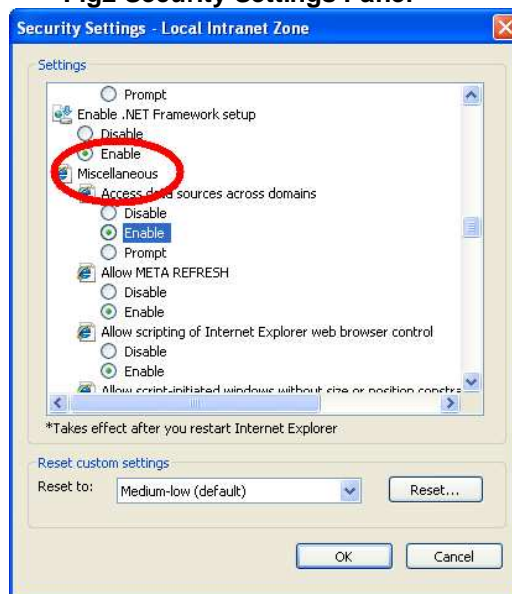

2. Under the **Miscellaneous** section of the Security Settings panel *Enable* the following items:

- Access data sources across domains
- Navigate sub-frames across domains \*

\* Note in IE8 this item has been renamed to ***Navigate windows and frames across different domains***.

**OPTIONAL** Adjusting the following setting will allow additional IMF functionality to be available ***this step is not required***.

3. Under the Scripting section *Enable*:

- Allow status bar updates via script.